

OPERATING & SAFETY GUIDE

GLASSWASHER



GENERAL SAFETY

Contact Blue Sky Event Hire for information and advice on the suitability and safety of this type of equipment. There is a risk of injury if you do not follow the instructions printed in this guide.

This equipment should only be used by a competent adult who has read and understood these instructions.

Anyone with a temporary or permanent disability should seek expert advice before using the equipment.

Keep all children, animals and bystanders away from the work area. Ensure the floor of the work area is free from trip hazards and non-slip. Never use the equipment if you are ill, tired or under the influence of alcohol or drugs.

Never operate electrical switches with wet hands.

Always switch off and unplug the equipment from the power supply before moving or cleaning. Check the equipment before use, if it shows signs of damage request a replacement.

ELECTRICAL SAFETY

The equipment is designed to plug directly into a standard 240volt, 13 amp socket. Make sure the equipment and power socket are switched off before plugging into the power supply.

If the equipment fails to operate or the power cable or plug becomes damaged, contact Blue Sky Event Hire. Do not try to repair it yourself.

Keep the power cable out of harm's way. Extension leads should be unwound fully, never run them through water, over sharp objects or where they may be a trip hazard.

Use a suitable RCD (Residual Current Operated Device) to reduce the risk of electric shock.

OPERATION

1 **Machine description :**

The design of commercial glass and dishwashing machines differ from their domestic versions as they are designed to run nearly continually for many hours.

2 **Controls :**

Prior to switching the machine ON ②, ensure that you are familiar with the controls on the front fascia of the appliance and the location of the isolator for mains electricity and water supply.



- ① ON / OFF lamp
- ② ON / OFF switch
- ③ Machine ready lamp
- ④ Cycle switch
- ⑤ Cycle lamp

Note !

Appliances fitted with a drain pump, the Cycle switch and lamp double as the drain down switch and lamp

OPERATING & SAFETY GUIDE

GLASSWASHER

**BLUE
SKY**

3 Switch the machine on :

Ensure that both the water and electrical supply are connected and switched on, then depress the 'ON/OFF' switch ② located on the fascia of the machine.

The machine will now automatically fill and heat, during this process the door should remain closed, allowing the process to be completed quickly.

4 Machine ready to operate :

It is IMPORTANT after switching the appliance on each day, to allow 25 minutes before starting the first wash cycle; regardless of the fact that the green Ready light ③ will already be illuminated.

The appliance is designed to only start a cycle when the correct temperatures are achieved, so there may be a pause between a cycle being selected and the cycle starting

5 Starting a cycle :



To start a cycle, open the door, load the first basket, ensuring that bottom and top arms rotate freely.

Close the door, then depress the 'Cycle' switch ④, the cycle will now start once the appliance has achieved its correct temperatures, during the cycle the 'Cycle' lamp ⑤ will be illuminated.



Once the 'Cycle' lamp ⑤ has gone out (at the end of the cycle) open the door and remove the basket, then reload the machine and repeat as required

6 Draining :

During normal operation your appliance will automatically drain away any excess water.

It is very important the machine is drained down at the end of each working day and the door is left open to allow drying.

The machine should never be left full of water if you are switching the machine off.



Gravity drain (typically Eco2).

- Switch appliance OFF at fascia ①.
- Remove drain plug from wash tank.
- Your appliance should now drain under gravity.
- Once completed replace the drain plug.
- Now isolate mains water and electricity at the wall.

6 Draining (cont.) :

Drain pump appliances (optional on Eco1, Eco2)

- Switch appliance OFF at fascia ①.
- Close the door.
- Now depress the 'Cycle' switch ④, the 'Cycle' lamp ⑤ will now illuminate to indicate that the drain cycle is in progress..
- Once the 'Cycle' lamp ⑤ goes out, switch the appliance Off at the wall, DO NOT switch isolate the appliance while in the drain down cycle.

Note !

Once empty 'Classeq' recommends that the mains water and electricity supplies are isolated at the wall and the machine be cleaned as instructed in section 6 of this manual



For hygiene reasons it is recommended that once the appliance has been drained that the door is left open to assist in natural drying of the wash chamber

CLEANING

1 Prior to cleaning :



Switch off and isolated electrical supply before cleaning the appliance

WARNING



DO NOT use cleaning agents that contain CHLORINE, BLEACH or HYPOCHLORITE.

DO NOT use STEEL WOOL, WIRE BRUSHES or any other abrasive materials.

DO NOT jet wash or hose pipe the appliance down either internally or on the exterior

2 Internal cleaning :

Remove the wash and rinse arms from the appliance, once removed wash in warm soapy water, ensuring all debris are removed, before reassembling the arm

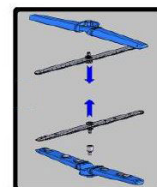

Remove all the filters from within the appliance and again wash in warm soapy water, ensuring all debris are removed.

WARNING



Before cleaning the wash chamber, ensure all sharp items, such as broken glass or other items which could cause injury are removed carefully

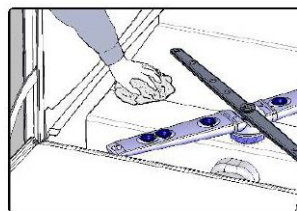

Now wipe the inside of the wash chamber ensuring any debris are removed and the chamber is clean, now reassemble all filters and wash arms.

TROUBLESHOOTING

1 Appliance does not fill : Appliance does not start : Appliance does not rinse :

- Check water supply is turned ON.
- Check water supply hose is not trapped or kinked.
- Check that the appliance is switched ON.
- Drain appliance fully, then try again to fill the machine, drain as per instructions 5.6 of this manual..

2 Appliance fills slowly :

- Check water supply tap is fully open.
- Check water supply pressure, should be above 2 bar, if not ask your dealer to install a booster pump to increase water pressure.
- Check and clean rinse jets (located on the wash arms within the appliance).
- Check water supply hose is not trapped or kinked.
- Remove any pressure regulator or reducer from the water supply.

3 Appliance not heating :

- Drain appliance fully, then try again to fill the machine, drain as per instructions 5.6 of this manual..
- Check the temperature of the mains water, as variations in water temperature will affect the heating of the appliance.
- Check that the wash chamber is full of water.

4 Appliance not draining :

- Check and clean all filters within the appliance.
- Check that the stand pipe / drain is not clogged / blocked.
- With drain pump appliance, bleed the pump as stated in section 3.4.2. of this manual.

5 Poor wash results :

- Check and replenish chemicals.
- Check and clean wash and rinse jets on wash arm assembly.
- Clean filters within appliance and check that they are fitted correctly.



- Check water supply is ON and fully open.
- Rinse dishes of any food debris before placing into the dish-washer.
- Glasses may need to be renovated.
- If glasses are 'Blooming' you may need a water softener, call your dealer to advise on size of water softener required.
- If a water softener is fitted, replenish the salt within the softener, as per the water softener instructions.

6 Overfilling :

- Drain appliance fully, then try again to fill the machine, drain as per instructions 5.6 of this manual.
- Check and clean all filters within the appliance.
- Check stand pipe / drain height is configured correctly shown in section 3.4.2. of this manual
- Check that the stand pipe / drain is not clogged / blocked.
- With drain pump appliance, bleed the pump as stated in section 3.4.2. of this manual.
- If the appliance continues to overfill isolate both the mains electricity and water, before call a service technician.

7 Will not switch ON :

- On an 13 amp appliance check and replace the fuse in the plug, ensuring the replacement fuse is of the correct rating.
- On other amperage appliances check and reset circuit breaker within the sites fuse board, if the circuit breaker continues to trip call a service technician immediately.

8 Will not switch OFF :

- Isolate at mains electricity before calling for a service technician immediately.